



# NORDIC

NORDIC TYPE, POPPET WITH DV

Edition. 21.0

## CS Carbon Steel

- Carbon Steel
- Type: Quick Couplings
- Models: Nordic type, with DV
- Sizes: from DN6 to DN25
- Pressure: up to PN400

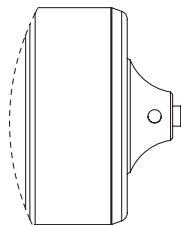
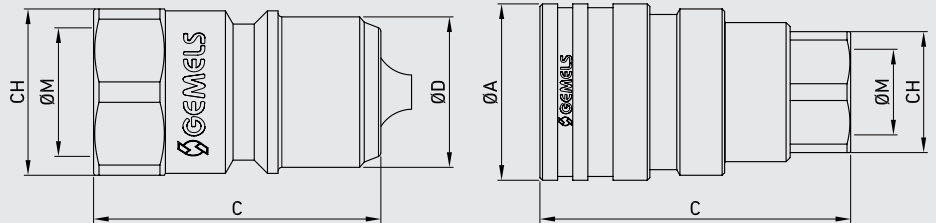

Special pin to connect parts under residual pressure.  
The pin could be mounted on both sides, male or female.  
The opposite side has to be a ISO A standard poppet.

During connection the residual pressure will release by the smaller holes.



## CODE DESCRIPTION STRUCTURE

**QC G1/2 M/F DN12,5 1 B**

**Type of coupling**

NORDIC TYPE, POPPET WITH DV

**Ends**

ISO 1179-1 BSPP	ANSI B.1.20.3	GAS POPPET WITH DECOMPRESSION VALVE	NPT POPPET WITH DECOMPRESSION VALVE
G1/4"	N1/4"	G3/8	G3/8
G3/8	N3/8	G1/2	G1/2
G1/2	N1/2	G3/4	G3/4
G3/4	N3/4	G1	G1
G1	N1		

MALE  
FEMALE

**DN/ISO**

6  
10  
12,5  
20  
25

**Body Material**

● 1 = 1,0737

**Seal material**

B = NBR E = FKM\*

\*On request

- Plugs
- Caps



Available colours:

- Blue
- Yellow
- Red
- Green

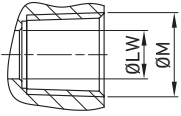

**QUICK COUPLINGS NORDIC TYPE (male / female)  
FEMALE THEREAD BSPP (ISO1179-1)**

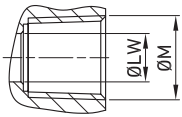
										CS Carbon Steel	
TYPE	DN	PN		ØA	C	Ød	ch	ØM	WEIGHT		ITEM CODE
QC NORDIC G1/4 MALE	6	MPa	40	mm	-	48,2	12	G1/4	kg	0,05	NC45G010000
		Psi	5800	inch	-	1,90	0,47		0,71	lb	
QC NORDIC G1/4 FEMALE	6	MPa	40	mm	26	60	-	G1/4	kg	0,15	NC46G010000
		Psi	5800	inch	1,02	2,36	-		0,83	lb	
QC NORDIC G3/8 MALE	10	MPa	33	mm	-	38	19,9	G3/8	kg	0,06	NC45G020000
		Psi	4785	inch	-	1,50	0,78		0,87	lb	
QC NORDIC G3/8 FEMALE	10	MPa	33	mm	35	61	-	G3/8	kg	0,22	NC46G020000
		Psi	4785	inch	1,38	2,40	-		0,94	lb	
QC NORDIC G1/2 MALE	12,5	MPa	34	mm	-	42,5	24,7	G1/2	kg	0,10	NC45G030000
		Psi	5000	inch	-	1,67	0,97		1,06	lb	
QC NORDIC G1/2 FEMALE	12,5	MPa	34	mm	41	67,5	-	G1/2	kg	0,33	NC46G030000
		Psi	5000	inch	1,61	2,66	-		1,18	lb	
QC NORDIC G3/4 MALE	20	MPa	33	mm	-	47	32,7	G3/4	kg	0,19	NC45G040000
		Psi	4785	inch	-	1,85	1,29		1,42	lb	
QC NORDIC G3/4 FEMALE	20	MPa	33	mm	52	76,4	-	G3/4	kg	0,58	NC46G040000
		Psi	4785	inch	2,05	3,01	-		1,50	lb	
QC NORDIC G1 MALE	25	MPa	33	mm	-	56,5	40,9	G1	kg	0,35	NC45G050000
		Psi	4785	inch	-	2,22	1,61		1,77	lb	
QC NORDIC G1 FEMALE	25	MPa	33	mm	62	92,4	-	G1	kg	0,97	NC46G050000
		Psi	4785	inch	2,44	3,64	-		1,77	lb	

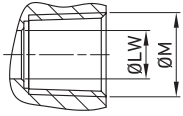

## QUICK COUPLINGS NORDIC TYPE (male / female) FEMALE THEREAD NPTF (ANSI B.1.20.3)

										CS Carbon Steel
TYPE	DN	PN	ØA	C	Ød	ch	ØM	WEIGHT		ITEM CODE
QC NORDIC N1/4 MALE	6	MPa 48,2	mm -	48,2	12	19	N1/4	kg	0,05	NC45N010000
		Psi 6989	inch -	1,90	0,47	0,75		lb	0,11	
QC NORDIC N1/4 FEMALE	6	MPa 40	mm 26	60	-	21	N1/4	kg	0,15	NC46N010000
		Psi 5800	inch 1,02	2,36	-	0,83		lb	0,32	
QC NORDIC N3/8 MALE	10	MPa 33	mm -	38	19,9	22	N3/8	kg	0,06	NC45N020000
		Psi 4785	inch -	1,50	0,78	0,87		lb	0,12	
QC NORDIC N3/8 FEMALE	10	MPa 33	mm 35	61,6	-	24	N3/8	kg	0,22	NC46N020000
		Psi 4785	inch 1,38	2,43	-	0,94		lb	0,48	
QC NORDIC N1/2 MALE	12,5	MPa 34	mm -	42,5	24,7	27	N1/2	kg	0,10	NC45N030000
		Psi 5000	inch -	1,67	0,97	1,06		lb	0,21	
QC NORDIC N1/2 FEMALE	12,5	MPa 34	mm 41	67,6	-	30	N1/2	kg	0,33	NC46N030000
		Psi 5000	inch 1,61	2,66	-	1,18		lb	0,72	
QC NORDIC N3/4 MALE	20	MPa 33	mm -	47	32,7	36	N3/4	kg	0,19	NC45N040000
		Psi 4785	inch -	1,85	1,29	1,42		lb	0,41	
QC NORDIC N3/4 FEMALE	20	MPa 33	mm 52	76,2	-	38	N3/4	kg	0,58	NC46N040000
		Psi 4785	inch 2,05	3,00	-	1,50		lb	1,27	
QC NORDIC N1 MALE	25	MPa 33	mm -	56,5	40,9	45	N1	kg	0,35	NC45N050000
		Psi 4785	inch -	2,22	1,61	1,77		lb	0,77	
QC NORDIC N1 FEMALE	25	MPa 33	mm 62	92	-	45	N1	kg	0,97	NC46N050000
		Psi 4785	inch 2,44	3,62	-	1,77		lb	2,17	

**QUICK COUPLINGS NORDIC TYPE (male / female)  
POPPET WITH DECOMPRESSION VALVE**

										CS Carbon Steel		
TYPE	DN	PN		ØA	C	Ød	ch	ØM	WEIGHT		ITEM CODE	
QC NORDIC G3/8 MALE	10	MPa	33	mm	-	38	19,9	22	G3/8	kg	0,06	NC47G020000
		Psi	4785	inch	-	1,50	0,78	0,87		lb	0,12	
QC NORDIC G3/8 FEMALE	10	MPa	33	mm	35	61	-	24	G3/8	kg	0,22	NC48G020000
		Psi	4785	inch	1,38	2,40	-	0,94		lb	0,48	
QC NORDIC G1/2 MALE	12,5	MPa	34,4828	mm	-	42,5	24,7	27	G1/2	kg	0,10	NC47G030000
		Psi	5000	inch	-	1,67	0,97	1,06		lb	0,21	
QC NORDIC G1/2 FEMALE	12,5	MPa	34,4828	mm	41	67,5	-	30	G1/2	kg	0,33	NC48G030000
		Psi	5000	inch	1,61	2,66	-	1,18		lb	0,72	
QC NORDIC G3/4 MALE	20	MPa	33	mm	-	47	32,7	36	G3/4	kg	0,19	NC47G040000
		Psi	4785	inch	-	1,85	1,29	1,42		lb	0,41	
QC NORDIC G3/4 FEMALE	20	MPa	33	mm	52	76,4	-	38	G3/4	kg	0,58	NC48G040000
		Psi	4785	inch	2,05	3,01	-	1,50		lb	1,27	
QC NORDIC G1 MALE	25	MPa	33	mm	-	56,5	40,9	45	G1	kg	0,35	NC47G050000
		Psi	4785	inch	-	2,22	1,61	1,77		lb	0,77	
QC NORDIC G1 FEMALE	25	MPa	33	mm	62	92,4	-	45	G1	kg	0,97	NC48G050000
		Psi	4785	inch	2,44	3,64	-	1,77		lb	2,17	

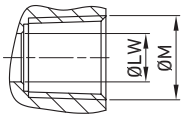

## QUICK COUPLINGS NORDIC TYPE (male / female) POPPET WITH DECOMPRESSION VALVE

TYPE	DN	PN		ØA	C	Ød	ch	ØM	WEIGHT		ITEM CODE	
		MPa	Psi						kg	lb		
QC NORDIC N3/8 MALE	10	MPa	33	mm	-	38	19,9	22	N3/8	kg	0,06	NC47N020000
		Psi	4785	inch	-	1,50	0,78	0,87		lb	0,12	
QC NORDIC N3/8 FEMALE	10	MPa	33	mm	35	61,6	-	24	N3/8	kg	0,22	NC48N020000
		Psi	4785	inch	1,38	2,43	-	0,94		lb	0,48	
QC NORDIC N1/2 MALE	12,5	MPa	34	mm	-	42,5	24,7	27	N1/2	kg	0,10	NC47N030000
		Psi	5000	inch	-	1,67	0,97	1,06		lb	0,21	
QC NORDIC N1/2 FEMALE	12,5	MPa	34	mm	41	67,6	-	30	N1/2	kg	0,33	NC48N030000
		Psi	5000	inch	1,61	2,66	-	1,18		lb	0,72	
QC NORDIC N3/4 MALE	20	MPa	33	mm	-	47	32,7	36	N3/4	kg	0,19	NC47N040000
		Psi	4785	inch	-	1,85	1,29	1,42		lb	0,41	
QC NORDIC N3/4 FEMALE	20	MPa	33	mm	52	76,2	-	38	N3/4	kg	0,58	NC48N040000
		Psi	4785	inch	2,05	3,00	-	1,50		lb	1,27	
QC NORDIC N1 MALE	25	MPa	33	mm	-	56,5	40,9	45	N1	kg	0,35	NC47N050000
		Psi	4785	inch	-	2,22	1,61	1,77		lb	0,77	
QC NORDIC N1 FEMALE	25	MPa	33	mm	62	92	-	45	N1	kg	0,97	NC48N050000
		Psi	4785	inch	2,44	3,62	-	1,77		lb	2,17	

 CS  
Carbon  
Steel